

Notice and Agenda

REGULAR MEETING — BOARD OF DIRECTORS — COUNTY SANITATION DISTRICT NO. 15

To be held at the OFFICE OF THE DISTRICT
1955 Workman Mill Road, Whittier, California

For the public to join the meeting virtually, click <https://us02web.zoom.us/j/8091438308> or enter the Meeting ID 809 143 8308 into the Zoom app on your smartphone or computer. Alternatively, you may join by phone by calling (669) 900-9128 and entering the Meeting ID. The meeting is not required to be broadcast via Zoom, but as a courtesy for public attendance. You may find further information at: <http://www.lacsd.org/agendas>

THE DISTRICT MAY TAKE ACTION ON ANY AGENDA ITEM LISTED BELOW

WEDNESDAY	September 27, 2023	At 1:30 P.M.
Governing Body	Director	Alternate
ARCADIA	CHENG	CAO
BALDWIN PARK	ESTRADA	M. GARCIA
BRADBURY	-----	BARAKAT (Chairperson)
DUARTE	SCHULZ	FINLAY
EL MONTE	ANCONA	MARTINEZ
INDUSTRY	MOSS	-----
IRWINDALE	ORTIZ	AMBRIZ
LA PUENTE	KLINAKIS	MUNOZ
MONROVIA	SHEVLIN	-----
MONTEBELLO	TORRES	JIMENEZ
MONTEREY PARK	SANCHEZ	WONG
PASADENA	GORDO	WILLIAMS
ROSEMEAD	LY	CLARK
SAN GABRIEL	HARRINGTON	DING
SAN MARINO	TALT	LO
SIERRA MADRE	E. GARCIA	KRIEBS
SOUTH EL MONTE	OLMOS	ANGEL
TEMPLE CITY	STERNQUIST	YU
WEST COVINA	CASTELLANOS	DIAZ
WHITTIER	VINATIERI	WARNER
LOS ANGELES COUNTY	HAHN	BARGER

1. Public Comment
2. Approve Minutes of Regular Meeting Held July 26, 2023
3. Approve May and June 2023 Expenses in Amount of \$21,071,828

Summary: Local District expenses represent costs that are the sole responsibility of the individual District. Allocated expenses, which are generally distributed twice per year in conjunction with the receipt of the District’s service charge revenue, represent the District’s proportionate share of expenses made by the Joint Outfall System pursuant to the Joint Outfall Agreement. The Agreement provides for the joint administration, technical support and management of the operations, maintenance, and capital costs associated with all the shared facilities for all of the signatory Districts, along with the methodology for determining the proportionate costs for each District. A listing of Districts’ payments and previously approved budgets can be found on the Districts’ website at lacsd.org/financial-documents. This item is consistent with the Districts’ Guiding Principle of commitment to fiscal responsibility and prudent financial stewardship.

Local District Expenses:	
Operations & Maintenance	\$ 9,649
Allocated Expenses:	
Joint Outfall	<u>21,062,179</u>
Total Expenses	<u>\$21,071,828</u>

4. Adopt Joint Resolution Approving and Accepting Negotiated Exchange of Property Tax Revenues Resulting from Annexation of Tract 65296 to County Lighting Maintenance District 1687 (Lighting District) Affecting County of Los Angeles, Greater Los Angeles County Vector Control District, Upper San Gabriel Valley Municipal Water District, and County Sanitation District No. 15

Summary: The Lighting District is proposing to annex territory located within the District’s service area. The Revenue and Taxation Code requires that the District and other agencies that are already providing

4. Contd.

service to the territory, and are receiving property tax revenue, adopt a joint resolution approving the amount of property tax revenue to be apportioned to the agency providing the new service. The apportionment is determined by the Los Angeles County Auditor-Controller. A map prepared by the Los Angeles County Department of Public Works showing the proposed annexation is attached. Staff has determined that adoption of the joint resolution does not constitute a “Project” under the California Environmental Quality Act (CEQA) pursuant to California Public Resources Code Section 21065 and Title 14 of the California Code of Regulations (“CEQA Guidelines”) Section 15378.

Adjourn

Status Report: Prior to or during the meeting session, the Chief Engineer and General Manager may update the Directors on various matters concerning the Districts that may be of current interest to the Directors.

Public Comment: Members of the public may address the Board of Directors on any item shown on the agenda or matter under the Board’s authority. A “Request to Address Board of Directors” form is available. In compliance with the Americans with Disabilities Act, if you require special assistance to participate in this meeting, please contact the Secretary to the Boards’ Office (562) 908-4288, extension 1100. Notification of 48 hours prior to the meeting will enable staff to make reasonable arrangements to ensure accessibility to this meeting. (28CFR 35.101 et seq. ADA Title II).

Document Requests: Links to supporting documents are available online at the time of posting. Agendas and supporting documents or other writings that will be distributed to Board members in connection with matters subject to discussion or consideration at this meeting that are not exempt from disclosure under the Public Records Act are available for inspection following the posting of this agenda at the office of the Secretary to the Boards of Directors located at the Districts’ Joint Administration Building, 1955 Workman Mill Road, Whittier, California, 90601, or at the time of the meeting at the address posted on this agenda.

TRACT 65296

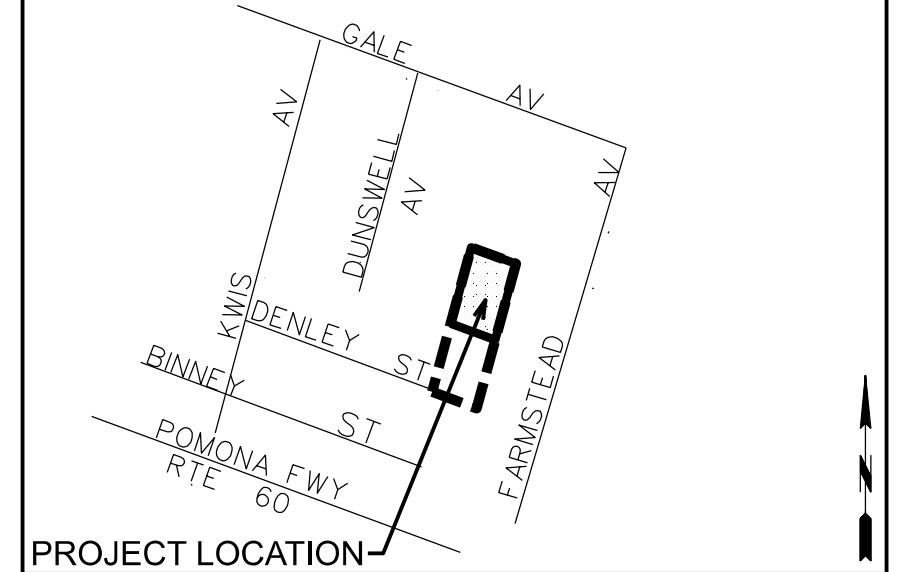
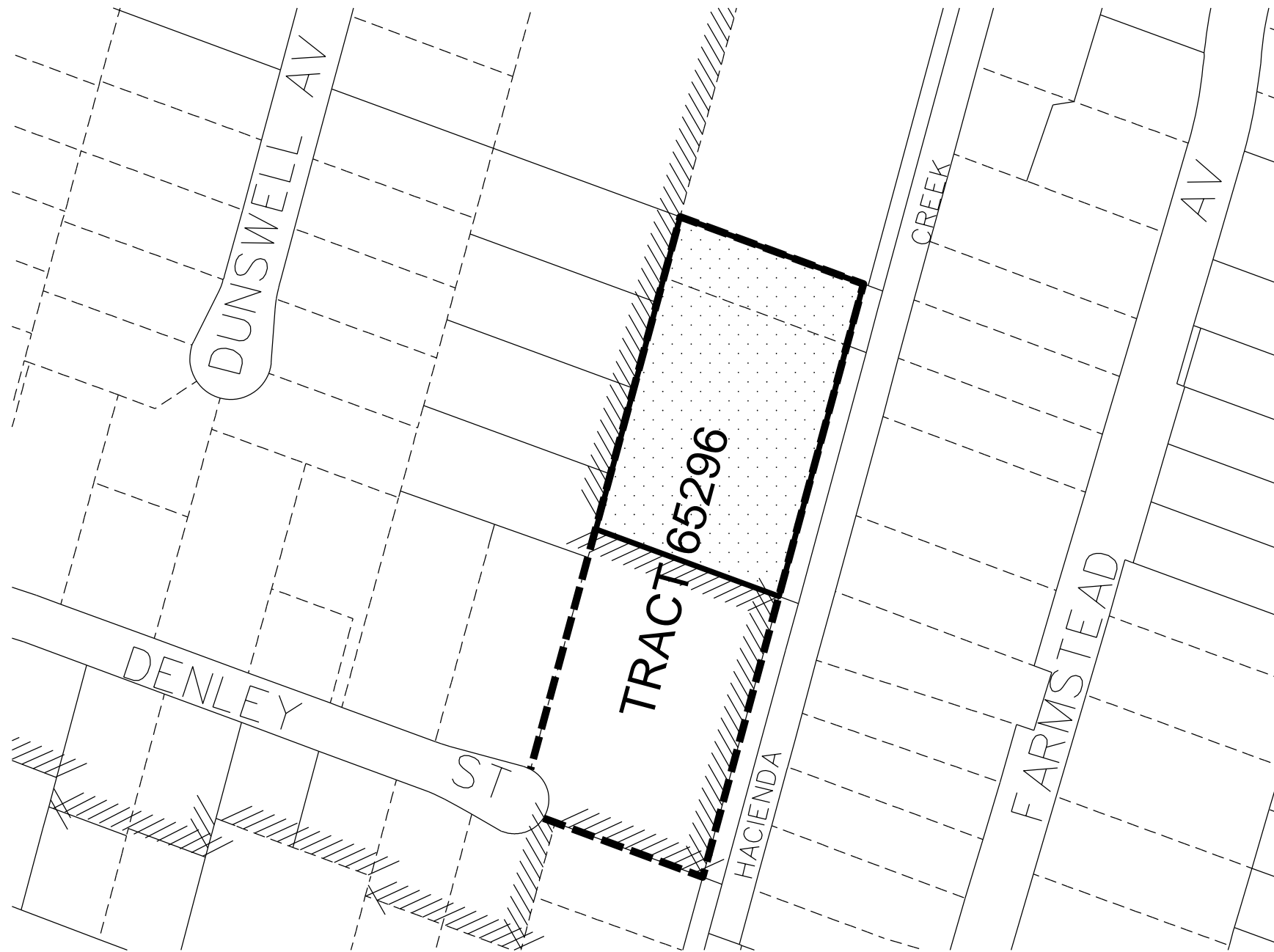



PROJECT LOCATION

VICINITY MAP

T.G. page 678-B2

TRA
04427
12008
APN
8218-017-052
8218-017-053

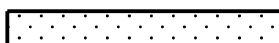
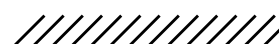
LEGEND

-  PROPOSED ANNEXATION AREA
-  EXISTING LIGHTING MAINTENANCE DISTRICT 1687
-  TRACT 65296 BOUNDARY

PROPOSED ANNEXATION TO COUNTY LIGHTING MAINTENANCE DISTRICT 1687 AND COUNTY LIGHTING DISTRICT LLA-1 (UNINCORPORATED ZONE)

LOS ANGELES COUNTY PUBLIC WORKS
TRAFFIC SAFETY AND MOBILITY DIVISION
STREET LIGHTING SECTION

CLMD 1687
HACIENDA HEIGHTS AREA

Prepared By TD	Sheet 1 of 1	Sup. Dist 1
Recommended By <i>Tigist Desta</i>	Date 7/13/2023	
Approved By <i>JHerrera</i>	Date 7/13/2023	

TR 65296

**JOINT RESOLUTION OF
THE BOARD OF SUPERVISORS OF THE COUNTY OF LOS ANGELES,
THE BOARD OF TRUSTEES OF THE GREATER LOS ANGELES COUNTY VECTOR
CONTROL DISTRICT, THE BOARD OF DIRECTORS OF THE COUNTY SANITATION
DISTRICT NO. 15 OF LOS ANGELES COUNTY, AND THE BOARD OF DIRECTORS
OF THE UPPER SAN GABRIEL VALLEY MUNICIPAL WATER DISTRICT
APPROVING AND ACCEPTING THE NEGOTIATED EXCHANGE OF
PROPERTY TAX REVENUES RESULTING FROM
ANNEXATION OF TRACT 65296
TO COUNTY LIGHTING MAINTENANCE DISTRICT 1687**

WHEREAS, pursuant to Section 99.01 of the California Revenue and Taxation Code, prior to the effective date of any jurisdictional change that will result in a special district providing one or more services to an area where those services have not previously been provided by any local agency, the special district and each local agency that receives an apportionment of property tax revenue from the area must negotiate an exchange of property tax increment generated in the area subject to the jurisdictional change and attributable to those local agencies; and

WHEREAS, the Board of Supervisors of the County of Los Angeles, acting on behalf of the County Lighting Maintenance District (CLMD) 1687, Los Angeles County General Fund, Los Angeles County Public Library, Los Angeles County Road District 1, the Consolidated Fire Protection District of Los Angeles County, Los Angeles County Flood Control Drainage Improvement Maintenance District, and Los Angeles County Flood Control District; the Board of Trustees of the Greater Los Angeles County Vector Control District; the Board of Directors of the County Sanitation District No. 15 of Los Angeles County; and the Board of Directors of the Upper San Gabriel Valley Municipal Water District have determined that the amount of property tax revenue to be exchanged between their respective agencies as a result of the annexation proposal identified as Tract 65296 to CLMD 1687 is as shown on the attached Property Tax Transfer Resolution Worksheet.

//
//
//
//
//
//
//
//
//
//
//

NOW, THEREFORE, BE IT RESOLVED AS FOLLOWS:

1. The negotiated exchange of property tax revenues between CLMD 1687, Los Angeles County General Fund, Los Angeles County Public Library, Los Angeles County Road District 1, the Consolidated Fire Protection District of Los Angeles County, Los Angeles County Flood Control Drainage Improvement Maintenance District, Los Angeles County Flood Control District, the Greater Los Angeles County Vector Control District, the County Sanitation District No. 15 of Los Angeles County, and the Upper San Gabriel Valley Municipal Water District resulting from the annexation of Tract 65296 to CLMD 1687 is approved and accepted.

2. For fiscal years commencing on or after July 1, 2024, or the July 1 after the effective date of this jurisdictional change, whichever is later, the property tax revenue increment generated from the area within Tract 65296, Tax Rate Area 04427, shall be allocated to the affected agencies as indicated on the Property Tax Transfer Resolution Worksheet.

3. No transfer of property tax revenues other than those specified in Paragraph 2 shall be made as a result of the annexation of Tract 65296.

4. If at any time after the effective date of this resolution, the calculations used herein to determine initial property tax transfers or the data used to perform those calculations are found to be incorrect, thus, producing an improper or inaccurate property tax transfer, the property tax transfer shall be recalculated and the corrected transfer shall be implemented for the next fiscal year.

PASSED, APPROVED, AND ADOPTED this _____ day of _____ 2023, by the following vote:

AYES:
NOES:
ABSENT:
ABSTAIN:

COUNTY SANITATION DISTRICT NO. 15
OF LOS ANGELES COUNTY

By _____
Chairperson, Board of Directors

ATTEST:

Secretary

Date

ANNEXATION TO: CO LIGHTING MAINT DIST NO 1687
 ACCOUNT NUMBER: 019.40
 TRA: 04427
 EFFECTIVE DATE: 07/01/2023
 ANNEXATION NUMBER: TR 65296 PROJECT NAME: TRACT 65296
 DISTRICT SHARE: 0.021423831

ACCOUNT #	TAXING AGENCY	CURRENT TAX SHARE	PERCENT	PROPOSED DIST SHARE	ALLOCATED SHARE	ADJUSTMENTS	NET SHARE
001.05	LOS ANGELES COUNTY GENERAL	0.329185036	32.9194 %	0.021423831	0.007052414	-0.007216871	0.321968165
001.20	L.A. COUNTY ACCUM CAP OUTLAY	0.000116841	0.0116 %	0.021423831	0.000002503	0.000000000	0.000116841
003.01	L A COUNTY LIBRARY	0.024080700	2.4080 %	0.021423831	0.000515900	-0.000515900	0.023564800
005.05	ROAD DIST # 1	0.005981114	0.5981 %	0.021423831	0.000128138	-0.000128138	0.005852976
007.30	CONSOL. FIRE PRO.DIST.OF L.A.CO.	0.179663030	17.9663 %	0.021423831	0.003849070	-0.003849070	0.175813960
007.31	L A C FIRE-FFW	0.007559538	0.7559 %	0.021423831	0.000161954	0.000000000	0.007559538
030.10	L.A.CO.FL.CON.DR.IMP.DIST.MAINT.	0.001801120	0.1801 %	0.021423831	0.000038586	-0.000038586	0.001762534
030.70	LA CO FLOOD CONTROL MAINT	0.010192934	1.0192 %	0.021423831	0.000218371	-0.000218371	0.009974563
061.80	GREATER L A CO VECTOR CONTROL	0.000387088	0.0387 %	0.021423831	0.000008292	-0.000008292	0.000378796
066.50	CO SANIT DIST NO 15 OPERATING	0.013684215	1.3684 %	0.021423831	0.000293168	-0.000293168	0.013391047
368.05	UPPER SAN GAB. VY. MUN. WATER	0.000591500	0.0591 %	0.021423831	0.000012672	-0.000012672	0.000578828
400.00	EDUCATIONAL REV AUGMENTATION FD	0.069138904	6.9138 %	0.021423831	0.001481220	EXEMPT	0.069138904
400.01	EDUCATIONAL AUG FD IMPOUND	0.131877650	13.1877 %	0.021423831	0.002825324	EXEMPT	0.131877650
400.15	COUNTY SCHOOL SERVICES	0.001449143	0.1449 %	0.021423831	0.000031046	EXEMPT	0.001449143
400.21	CHILDREN'S INSTIL TUITION FUND	0.002876030	0.2876 %	0.021423831	0.000061615	EXEMPT	0.002876030
809.04	MT.SAN ANTONIO COMMUNITY COLLEGE	0.031039726	3.1039 %	0.021423831	0.000664989	EXEMPT	0.031039726
809.20	MT SAN ANTONIO CHILDRENS CTR FD	0.000299596	0.0299 %	0.021423831	0.000006418	EXEMPT	0.000299596
870.03	HACIENDA-LA PUENTE UNIF. SCH.DIS	0.181519570	18.1519 %	0.021423831	0.003888844	EXEMPT	0.181519570
870.06	CO.SCH.SER.FD.HACIENDA-LA PUENTE	0.007668805	0.7668 %	0.021423831	0.000164295	EXEMPT	0.007668805

ANNEXATION NUMBER: TR 65296 PROJECT NAME: TRACT 65296 TRA: 04427

ACCOUNT #	TAXING AGENCY	CURRENT TAX SHARE	PERCENT	PROPOSED DIST SHARE	ALLOCATED SHARE	ADJUSTMENTS	NET SHARE
870.07	DEV.CTR.HDCPD.MINOR-HACI-LA PUTE	0.000887460	0.0887 %	0.021423831	0.000019012	EXEMPT	0.000887460
***019.40	CO LIGHTING MAINT DIST NO 1687	0.000000000	0.0000 %	0.021423831	0.000000000	0.000000000	0.012281068
TOTAL:		1.000000000	100.0000 %		0.021423831	-0.012281068	1.000000000